

SLB-0114

Double Arm Side of Pole/ Wall Mount

(For use with Solarland SLP085-SLP160,
CSA & CI D2 Series panels)



The Solarland® SLB-0114 has been specifically designed to be used with the Solarland® SLP Series panels ranging in size from 85W -160W. The double arm bracket provides a safe and secure mount to a pole, wall or fence.

Specifications

| | |
|-------------------|--|
| Mounting Type | Double Arm Side of Pole/Wall Mount |
| Module Type | Specifically designed to work with Solarland SLP series panels, but can be adapted for use with other panels |
| Number of Modules | Mounts 1 Panel |
| Setting Angle | 0°-90° |
| Wind Load | Designed to withstand wind speeds of 90mph |
| Snow Loading | 1.1kN/m ² |
| Warranty | 5 Years |

Kit Components

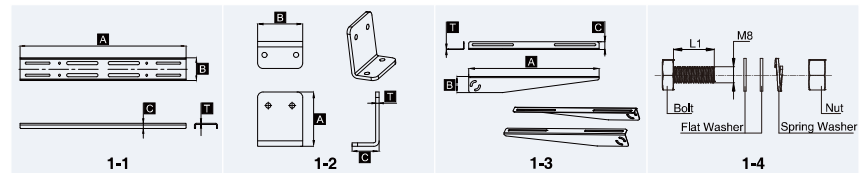

| Diagram | Component | Material | Surface Treatment | Quantity | Dimensions |
|---------|---------------|----------|-------------------|----------|--|
| 1-1 | Fixed Bracket | 5052Al | N/A | 1 | A=800mm[31.50in.], B=110mm[4.33in.] C=25mm[0.98in.], T=5.0mm[0.20in.] |
| 1-2 | Fixed Bracket | 5052Al | N/A | 2 | A=100mm[3.94in.], B=83mm[3.27in.] C=50mm[1.97in.], T=6.0mm[0.24in.] |
| 1-3 | Tilt Arm | 5052Al | N/A | 2 | A=675mm[26.57in.], B=82mm[3.23in.] C=50mm[1.97in.], T=3mm[0.12in.] |
| 1-4 | Module Bolt | AISI304 | N/A | 4 | M8X25[0.98in.] |
| | Mounting Bolt | AISI304 | N/A | 8 | M8X25[0.98in.] |

*Note: U-Bolts or Steel Clamps are not supplied in this kit and must be procured separately if pole mount is required

Mounting Diagram

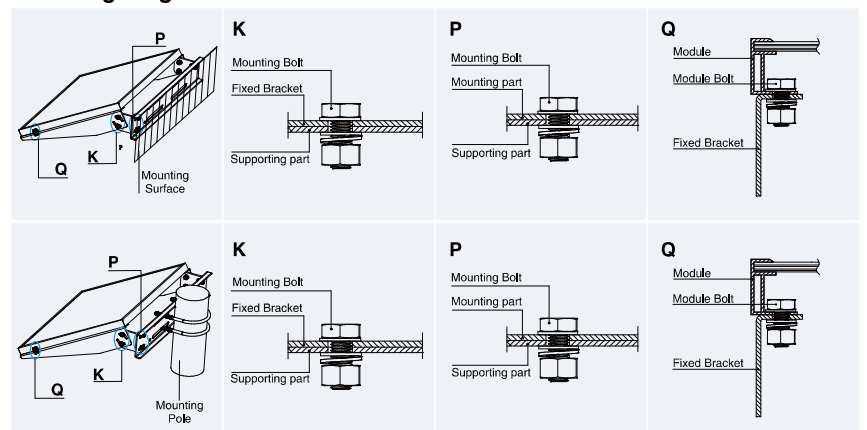

Note:

- When using this kit with another brand of panel you may need to change the module bolts to suit the mounting holes on the panel. M8 & M6 bolts are provided with this kit for your preference.

Office Address

301 Doubleday Ave. Ontario, CA 91761

Phone

tf. 1-800-605-9718 t. 1-909-937-7187
f. 1-909-533-2562

Network

Email

sales@solarlandusa.com

Website

www.solarlandusa.com